

Coaxial Circulator

CC 12.4

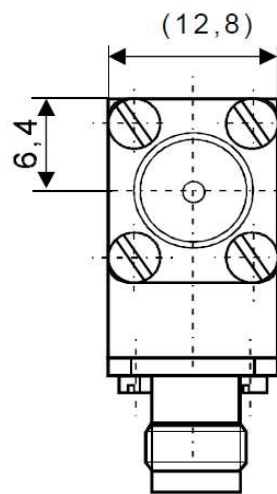
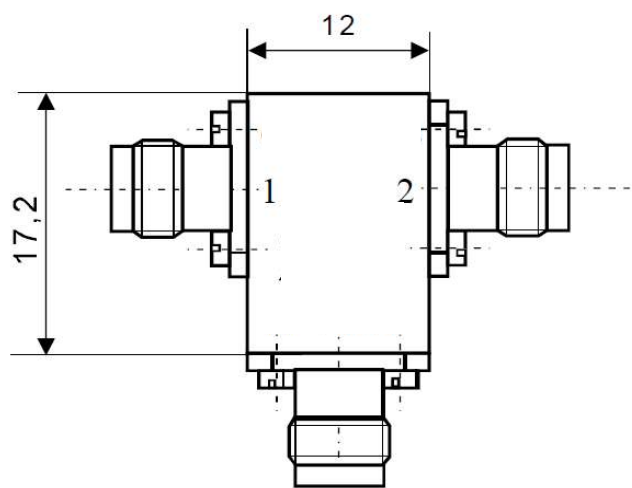

Electrical Specifications

	Min	Max	Unit
Operating Frequency	11,7	13,1	GHz
Insertion Loss		0,7	dB
Isolation	15		dB
VSWR		1,5	
Forward Power		1	W
Reverse Power		1	W

Mechanical Specifications

Interface/ Connectors	SMA-
Direction	CW
Weight	25 g
Housing Material	AlMgSi ; Steel
Surface	Conversion Coating; Ni-coated

Environmental Specifications

Operating Temp. Range (°C)	-10	+70
----------------------------	-----	-----