

Coaxial Circulator

CC 13.75 aaa

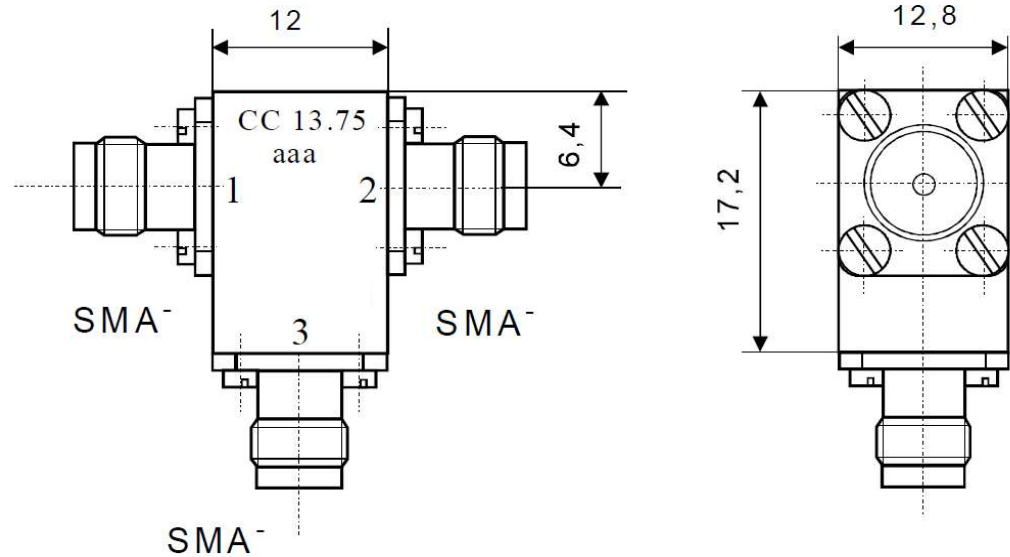

Electrical Specifications

	Min	Max	Unit
Operating Frequency	13	14,5	GHz
Insertion Loss		0,35	dB
Isolation	22		dB
VSWR		1,22:1	
Forward Power		1	W
Reverse Power		1	W

Mechanical Specifications

Interface/ Connectors	SMA -
Direction	CW
Weight	25 g
Housing Material	AlMgSi; Steel
Surface	Conversion Coating; Ni-coated

Environmental Specifications

Operating Temp. Range (°C)	-10	+65
----------------------------	-----	-----