

Coaxial Circulator

CC 700-600 W

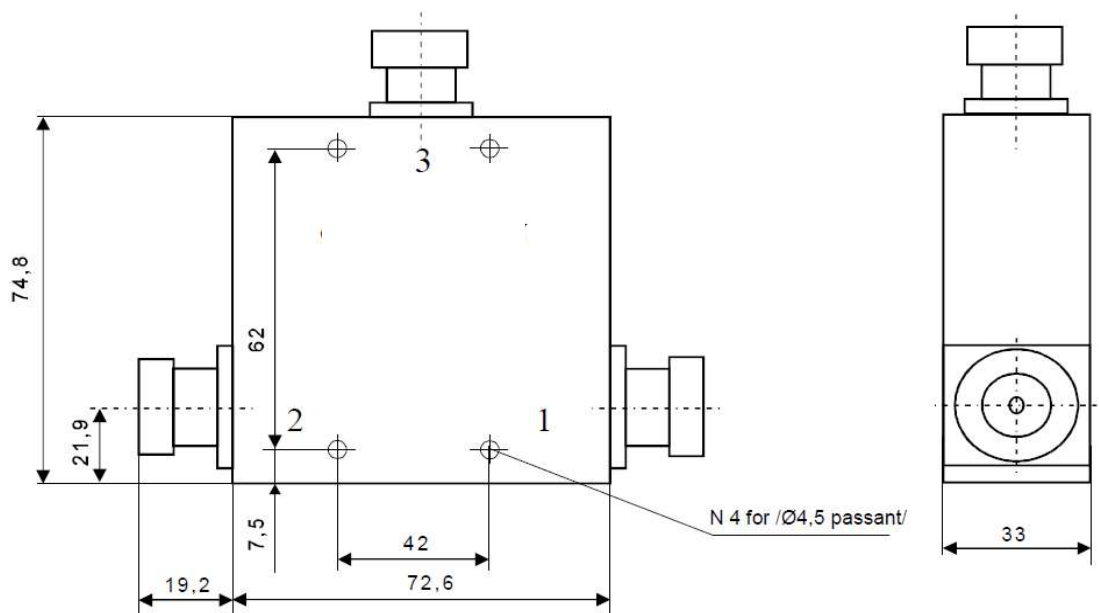

Electrical Specifications

	Min	Max	Unit
Operating Frequency	0,65	0,76	GHz
Insertion Loss		0,2	dB
Isolation	23		dB
VSWR		1,15:1	
Forward Power		600	W
Reverse Power		600	W

Mechanical Specifications

Interface/ Connectors	7/16-
Direction	CW
Weight	800 g
Housing Material	AlMgSi; Steel
Surface	Conversion Coating; Ni-coated

Environmental Specifications

Operating Temp. Range (°C)	-10	+70
----------------------------	-----	-----