

Coaxial Circulator CC 920

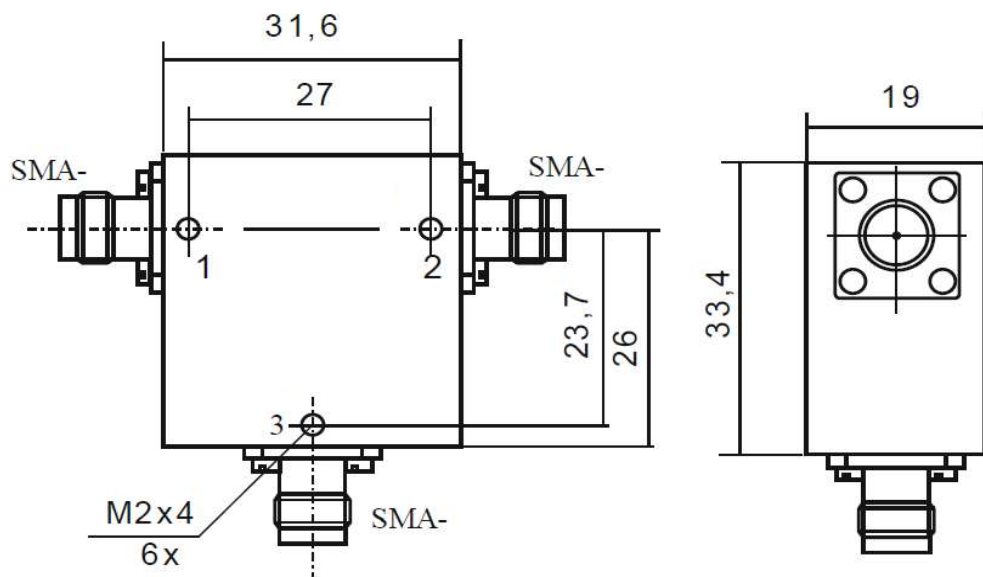

Electrical Specifications			
	Min	Max	Unit
Operating Frequency	0,88	0,96	GHz
Insertion Loss		0,3	dB
Isolation	23		dB
VSWR		1,15	
Forward Power		100	W
Reverse Power		100	W

Mechanical Specifications	
Interface/ Connectors	SMA -
Direction	CW
Weight	100 g
Housing Material	AlMgSi; Steel
Surface	Conversion Coating; Ni-coated

Environmental Specifications		
Operating Temp. Range (° C)	-10	+70