

Waveguide Circulator CW 7.5-I

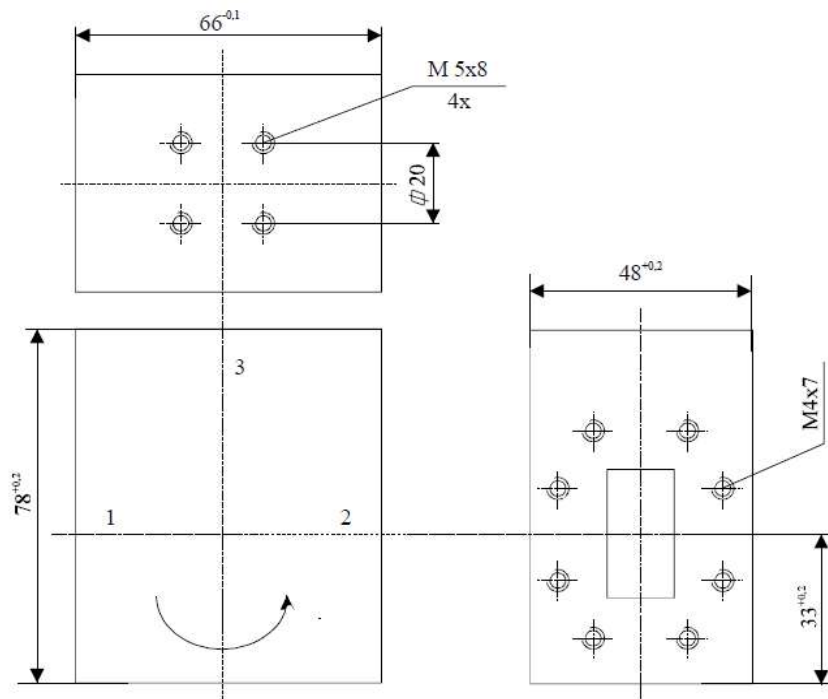

Electrical Specifications

	Min	Max	Unit
Operating Frequency	7,1	7,9	GHz
Insertion Loss		0,3	dB
Isolation	20		dB
VSWR		1,1	
Forward Power		1	W
Reverse Power		1	W

Mechanical Specifications

Interface/ Connectors	UDR/ UBR/ UER 84
Direction	CCW
Weight	700 g
Housing Material	AlMgSi; Steel
Surface	Conversion Coating; Ni-coated

Environmental Specifications

Operating Temp. Range (Celcius)	-40	+80
---------------------------------	-----	-----