

Coaxial Isolator

IC 2.00-10W

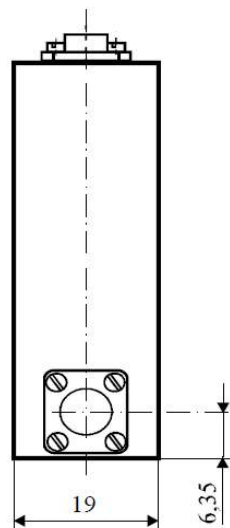
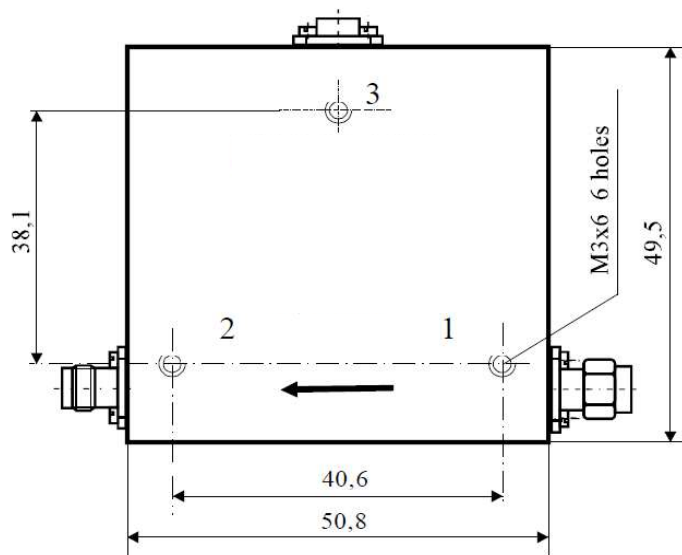

Electrical Specifications

	Min	Max	Unit
Operating Frequency	1,5	2,5	GHz
Insertion Loss		0,5	dB
Isolation	20		dB
VSWR		1,25:1	
Forward Power		20	W
Reverse Power		10	W

Mechanical Specifications

Interface/ Connectors	SMA+; -
Direction	CW
Weight	175 g
Housing Material	AlMgSi; Steel
Surface	Conversion Coating; Ni-coated

Environmental Specifications

Operating Temp. Range (°C)	-40	+85
----------------------------	-----	-----