

## Waveguide Isolator

### IFW 25.5

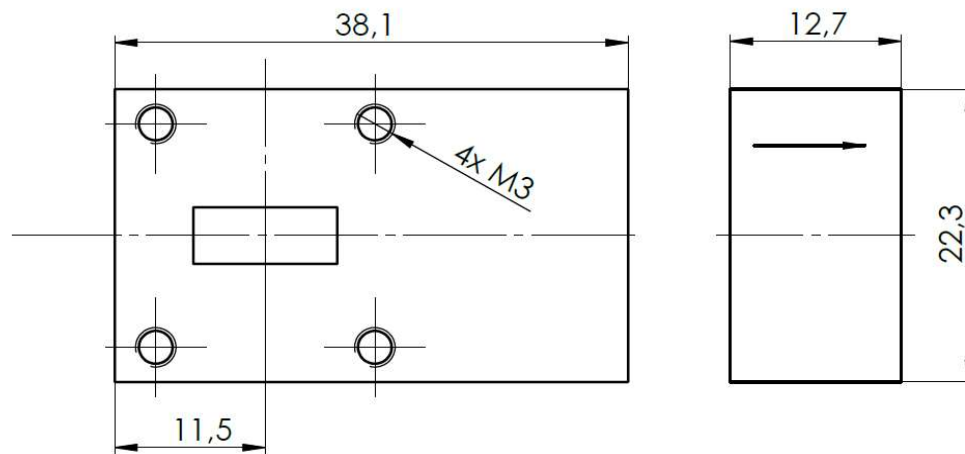

#### Electrical Specifications

	Min	Max	Unit
Operating Frequency	24,5	26,5	GHz
Insertion Loss		0,5	dB
Isolation	20		dB
VSWR		1,22	
Forward Power		1	W
Reverse Power		1	W

#### Mechanical Specifications

Interface/ Connectors	WR 42/ UBR 220
Direction	marked on the device
Weight	60 g
Housing Material	AlMgSi; Steel
Surface	Conversion Coating; Ni-coated

#### Environmental Specifications

Operating Temp. Range (°C)	-40	+80
----------------------------	-----	-----